

Installation Steps:

1. Prepare the Opening:

Create a drywall opening with the dimensions of 13-1/8" x 13-1/8". See "Suggested Drywall Opening" in the image.

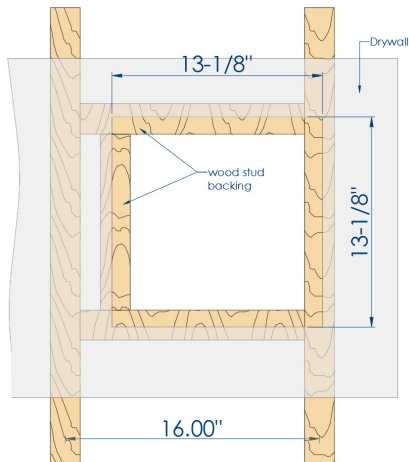

Wood frame opening

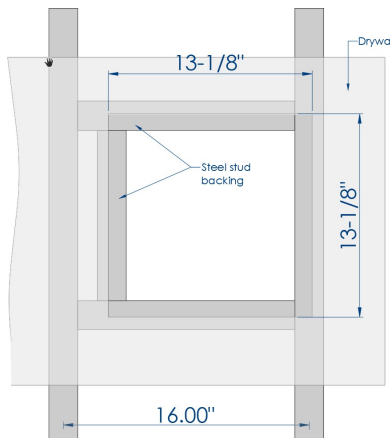

Steel frame opening

2. Framing:

Ensure proper framing with wood or steel studs, with a suggested stud spacing of 16" on center. provide structural integrity and facilitate standard panel size. Incorporate adequate backing, such as horizontal and Vertical blocking.

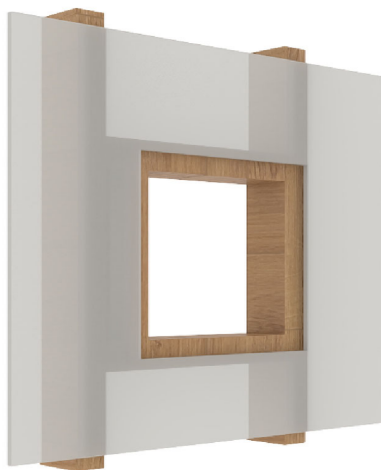

3. Panel Placement:

Position the access panel cover into the prepared opening and make sure it is leveled.

4. Securing the Panel with screws:

Use 1 1/4" (32mm) screws to secure the panel to the wood/steel stud system through the pre-drilled screw guide holes on all four sides.

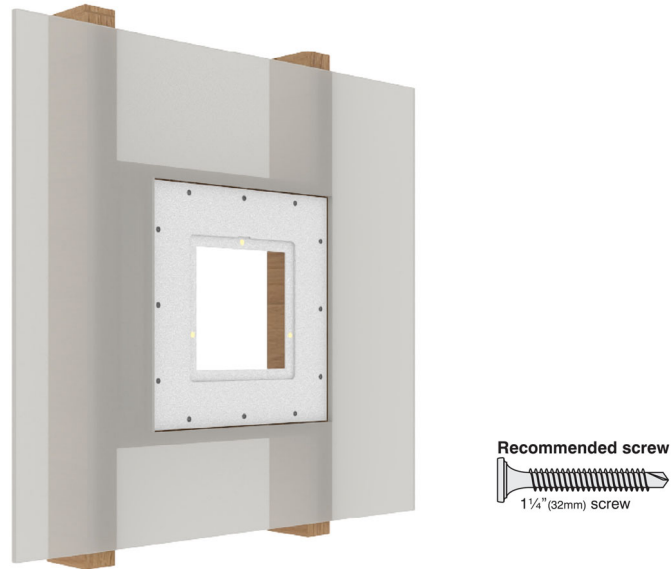

5. Finishing:

Apply drywall tape and joint compound to the "mud-in" area (1mm deep) to blend the panel seamlessly with the surrounding wall or ceiling surface.

Finish the surface as you would with regular drywall.

Paint the pre-primed product to match the existing wall color

6. Mounting Access panel:

Magnetic removable access panel can be mounted at the provided magnetic landing pads.

